

LEGEND

- 1 BUS TRANSPORTATION
- 2 REGISTRATION / LOBBY CONCIERGE
- 3 WHISPERING CANYON CAFE
- 4 WILDERNESS LODGE MERCANTILE
- 5 BUTTONS & BELLS ARCADE
- 6 CUB'S DEN CHILDREN'S ACTIVITY CENTER
- 7 TERRITORY LOUNGE
- 8 ARTIST POINT
- 9 ROARING FORK
- 10 GUEST LAUNDRY FACILITY

- 11 SILVER CREEK FALLS
- 12 SILVER CREEK
- 13 SILVER CREEK SPRINGS (POOL)
- 14 WADING POOL
- 15 SILVER CREEK SPAS
- 16 NW DOCK & FERRY/BOAT TRANSPORTATION
- 17 FIRE ROCK GEYSER
- 18 TROUT PASS POOL BAR

- 19 TETON BOAT & BIKE RENTAL
- 20 NATURE TRAIL
- 21 HIDDEN SPRINGS SPA
- 22 HIDDEN SPRINGS POOL
- 23 BIKE & JOGGING PATH
- 24 STURDY BRANCHES HEALTH CLUB
- PLAYGROUND
- DISNEY'S MAGICAL EXPRESS BUS STOP
- DISNEY VACATION CLUB INFORMATION CENTER
- DESIGNATED SMOKING LOCATION

 AUTOMATED EXTERNAL DEFIBRILLATOR



ROOM # _____

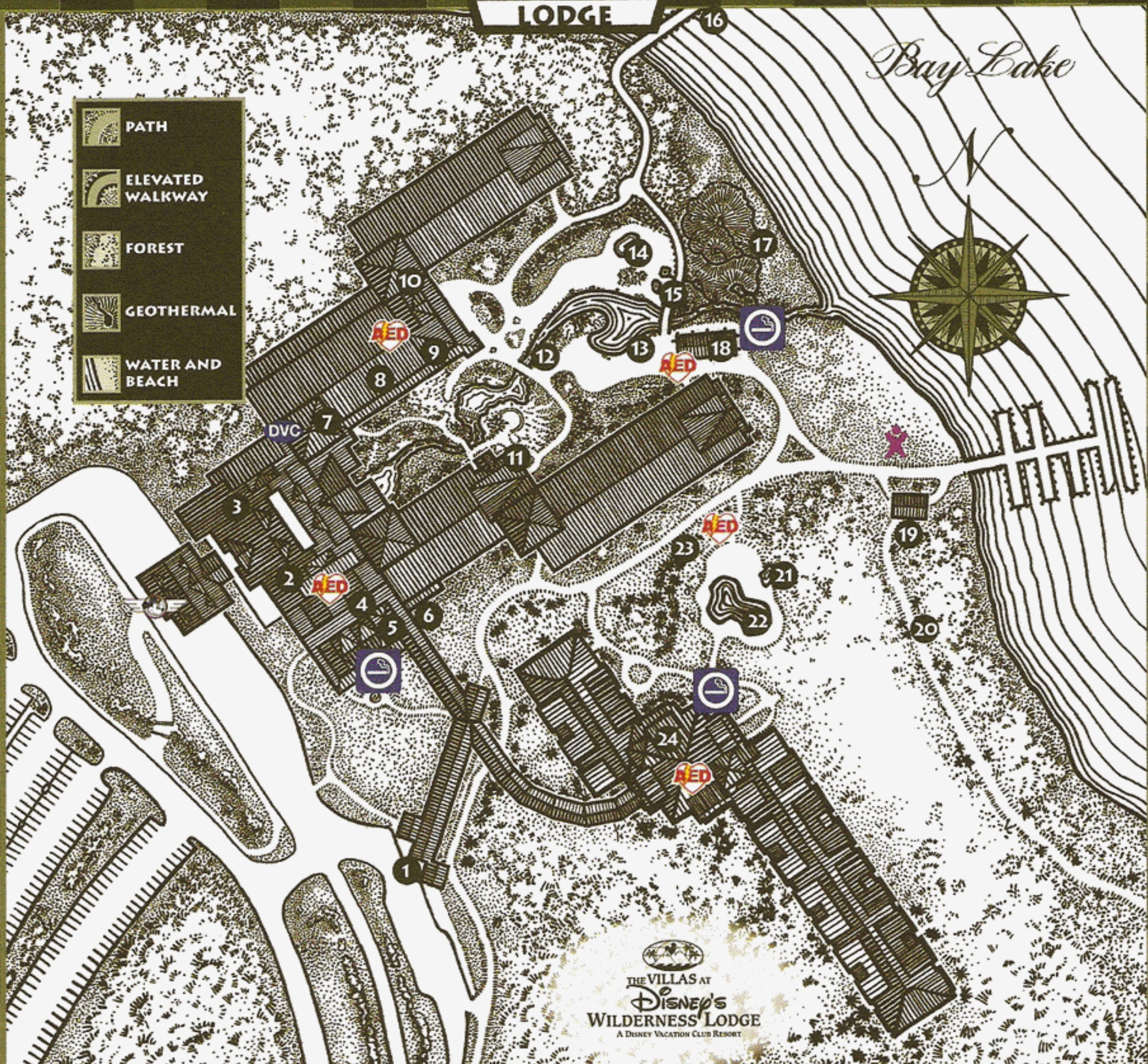

THE VILLAS AT
Disney's WILDERNESS LODGE
 A DISNEY VACATION CLUB RESORT